

Important Information for Family/Friend Visits

Thank you for your patience during these unprecedented times. As we continue to work to ensure the health and safety of people supported, please review the guidelines below:

Visits will NOT be allowed if the home is in an outbreak or if anyone in the home or visiting the home is awaiting COVID-19 test results or presents symptoms associated with COVID-19.

All visits are at the discretion of management and will occur only when it is in the best interest of the person supported and safe to do so.

Before the visit occurs, everyone must answer a series of screening questions and agree to have their temperature taken.

Our staff may have additional requests. Your cooperation will help them keep everyone safe. While we know how much your visit means to your family member or friend, our priority will continue to be keeping our home outbreak-free for the safety of people supported and staff.

Please understand that visits may need to end early or be cancelled due to multiple reasons; weather, outbreaks at the site, failure to pass pre-screening questions, if people and/or staff are symptomatic and/or are awaiting COVID-19 test results, or other unforeseen events.

If you have a gift for your loved one, please ask a member of our staff where to leave it, so that it can be sanitized for everyone's safety.

In the 14-days following your visit, if you have tested positive for COVID-19 or someone you are in close contact with has tested positive for COVID-19 you must call us immediately at 905-453-8841.

We thank you for your cooperation.

For the protection of our people supported and staff, please follow these directions during your visit:



Clean your hands. Clean your hands using hand sanitizer or soap and water. Refer to page 3 and 4 on proper procedure.



Wear a mask. You must continue to wear your mask at all times during your visit. Refer to page 5 on proper procedure.



Stay in designated areas. To beat COVID-19 we need to follow public health advice. Please help our staff by keeping to designated visiting areas when visiting our homes.

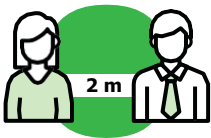

Maintain physical distance. We know, this one is hard. But for everyone's safety, avoid physical contact during your visit. It is a requirement to stay two metres (six feet) apart at all times!

How to handwash

Lather hands for 15 seconds



1 Wet hands with warm water.

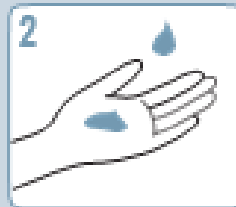

2 Apply soap.

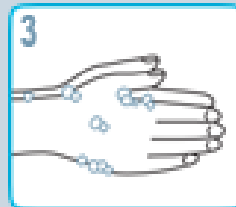

3 Lather soap and rub hands palm to palm.



4 Rub in between and around fingers.

Lather hands for 15 seconds

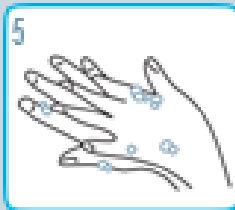

5 Rub back of each hand with palm of other hand.



6 Rub fingertips of each hand in opposite palm.

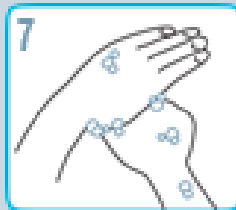

7 Rub each thumb clasped in opposite hand.



8 Rinse thoroughly under running water.



9 Pat hands dry with paper towel.



10 Turn off water using paper towel.

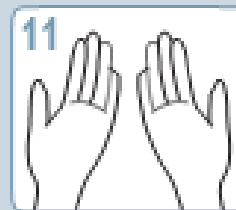

11 Your hands are now safe.



**JUST CLEAN
 YOUR HANDS**

For more information, please contact handhygiene@oahpp.ca
 or visit publichealthontario.ca/JCYH



How to handrub

(preferred method)



JUST CLEAN
YOUR HANDS

Rub hands for 15 seconds



1 Apply 1 to 2 pumps of product to palms of dry hands.



2 Rub hands together, palm to palm.



3 Rub in between and around fingers.



4 Rub back of each hand with palm of other hand.



5 Rub fingertips of each hand in opposite palm.



6 Rub each thumb clasped in opposite hand.



7 Rub hands until product is dry. Do not use paper towels.



8 Once dry, your hands are safe.

For more information, please contact handhygiene@oahpp.ca or visit publichealthontario.ca/JCYH.



COVID-19

Stop infection Wear a mask

When it's hard to maintain physical distance and where mandatory inside public spaces.



Before putting on your mask, **wash your hands** with soap and water for at least 20 seconds or use alcohol-based hand sanitizer.



Secure the **elastic loops** or ties of the mask around your ears.



Cover your **nose, mouth and chin** with the mask and make sure there are no gaps between your face and the mask.



Do not touch the front of the mask while you wear it. If you accidentally touch your mask, clean your hands.

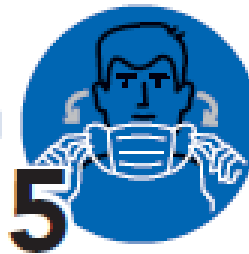

To **take off the mask**, remove the elastic loops or ties of the mask from around your ears.

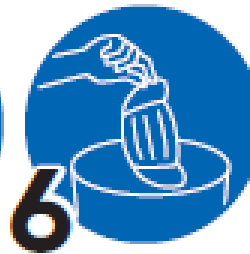

Hold **only the loops or strings** and place the mask in a garbage bin with a lid, or if reusable, directly into the laundry.



Wash your hands with soap and water for at least 20 seconds or use alcohol-based hand sanitizer after you have discarded your mask.

©2020 2020

For more information visit peelregion.ca/coronavirus

@regionofpeel @peelregion.ca @regionofpeel